

SWTB-C3000VSP-Poles, Vertical Header, 3.00mm pitch

Features

Mechanical Properties

Parameter:	Description
Connector Type:	DIP, dual row
Orientation:	Vertical
Dimensions:	See table
Operating Temperature Range:	-40°C~+105°C
Pitch:	3.00 mm
Poles:	2-24 Poles
Insulator body:	LCP, UL94V-0
Contact:	Brass, Tin plated over Nickel
Solder Nail:	Brass, Tin plated over Nickel



Typical applications

- Wire to Board
- Board to Wire

Electrical Properties

Parameter:	Description
Rated Voltage:	250V AC / DC
Rated Current:	5A AC / DC
Contact Resistance:	10mΩ Max.
Insulation Resistance:	1000MΩ Min.
Withstanding Voltage	1500V AC / 1Min.

Description

The SWTB-C3000VSP-Poles is a Dip style connector with 3.00 mm pitch.
The connector is available up to 24 poles in both Horizontal and Vertical orientation.

SWTB-C3000VSP-Poles, Vertical Header, 3.00mm pitch

Dimensions

*unit: mm

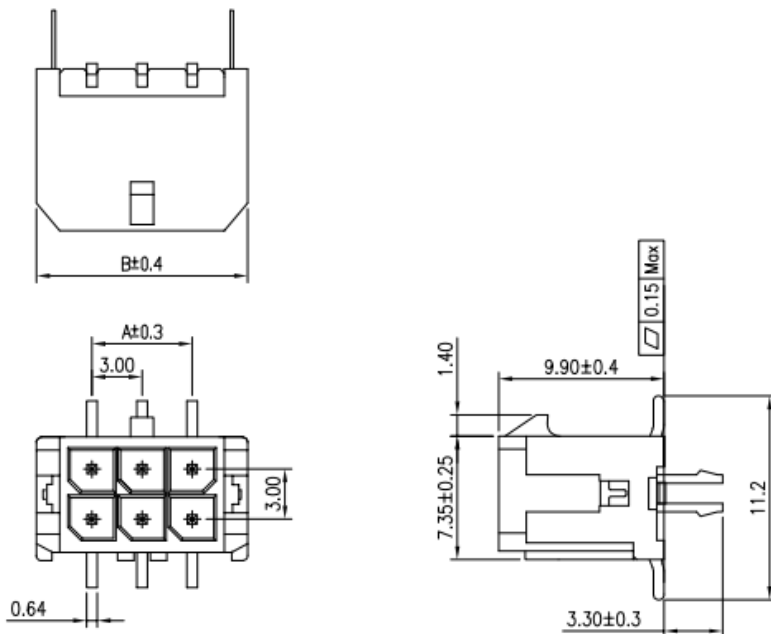

Number of Poles:	Dimensions	
	A	B
2*1P	--	6,65
2*2P	3,00	9,65
2*3P	6,00	12,65
2*4P	9,00	15,65
2*5P	12,00	18,65
2*6P	15,00	21,65
2*7P	18,00	24,65
2*8P	21,00	27,65
2*9P	24,00	30,65
2*10P	27,00	33,65
2*11P	30,00	36,65
2*12P	33,00	39,65

PCB Footprint

*unit: mm

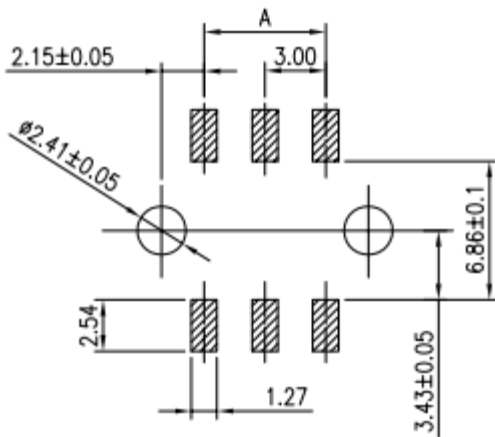

Ordering information

Ordering can be done via www.summit-electronics.com or via info@summit-electronics.com. Please contact us for more information. Customisation of the product is available on request.

Technical support

For all product questions please contact us via info@summit-electronics.com